

Equipment Required For Pump Set Up:

1. Ensure you have the following items:
 - a. **D-mine[®] Pump**
 - b. **D-mine[®] Pump Docking Station**
 - c. **Dacepton[®] 20ml Vial**
 - d. **Infusion Line**
 - e. **D-mine[®] Pump Reservoir**
 2. Ensure you have a clean work surface
 3. Wash your hands thoroughly prior to setting up infusion
 4. Change the battery each day prior to setting up the infusion
- Note:** dispose of sharps (such as used needles) as per local requirements (usually a sharps bin or equivalent)

Preparing the infusion:

1. Remove the D-mine[®] pump reservoir from its packaging



2. Insert reservoir into pump clicking it firmly into place.



3. Press to confirm "New Reservoir" then Confirm "Display & Sound OK"

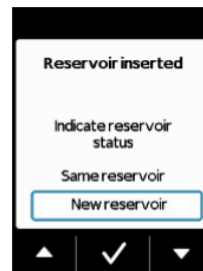

4. Remove orange cap and place vial into docking station



5. Turn the pump upside down and push the white adaptor onto the vial firmly. Turn the pump upright. Confirm on the pump when the vial is attached.

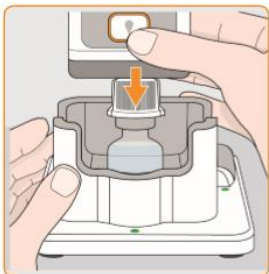

6. With the vial attached place the pump upright in the docking station. Follow instructions on the screen to start the filling process.



7. After the filling process is complete unscrew the vial from the pump and discard. Press



8. Attach the infusion line to the pump firmly screwing it into place. Confirm each instruction displayed on the pump screen.

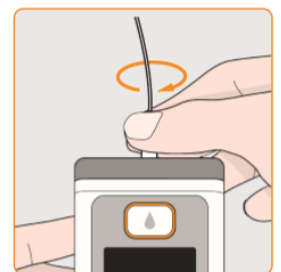

Injecting and Starting the Infusion

After the infusion line has been attached, confirm each instructions by pressing  :

1. “Stand pump in docking station” and confirm
2. The pump will then say “Pump is being prepared” – allow a moment for this
3. You will then have the option to prime the infusion line – select Yes or No
 - a. **If Yes is selected** - you can stop priming by pressing “stop” when the line is primed
 - b. **If No is selected** – you may insert the needle dry. The line will fill when the infusion is commenced
 - c. **Ask your Specialist for advice on priming the infusion line**
4. Insert the infusion line as per the advice of your Specialist and confirm on the pump
5. To start the infusion, press the **Start** button for a few seconds – the Basal Rate and bolus information will illuminate

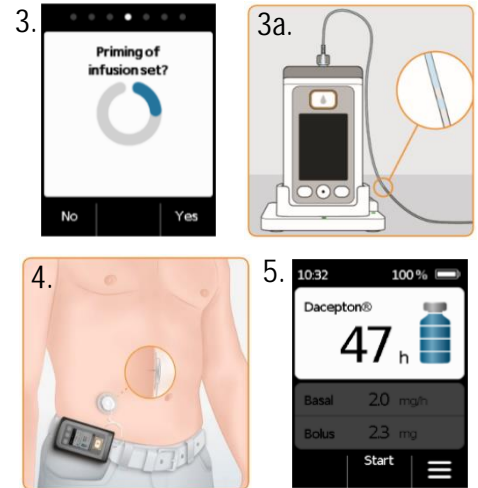

Stopping the Infusion

1. Stop the infusion by confirming **Stop** on the pump



Note: you may use any leftover medication the following day (for up to 7 days). The number of remaining hours is shown on the screen.

If you are using the remainder the following day, please leave the pump reservoir intact. You will need to remove the used infusion line and replace it when you are ready to begin the infusion again.

Refer to step 8 of “Preparing the Infusion”

If the reservoir is empty, please continue with the steps below:

2. Remove the infusion line from the skin and the infusion pump. Dispose of the infusion line safely

3. Remove the used reservoir from the pump by firmly pressing the grey button on the side of the pump



4. Dispose of the used reservoir in your recycle bin and return the pump to the docking station for charging overnight

For support related to your Dacepton[®] therapy call the D-mine[®] Care support line on 0800 254 0175 or email dminecare.uk@everpharma.com

For technical support for your D-mine[®] equipment please call 0800 254 0175 24 Hours a day* or email info.uk@everpharma.com

Any side effects or device malfunction should be reported to your doctor or nurse. You can also report side effects directly via the Yellow Card Scheme at www.mhra.gov.uk/yellowcard. Adverse events should also be reported to Medical Information on 0800 254 0174 or info.uk@everpharma.com By reporting side effects, you can help provide more information on the safety of this medicine.

*At busy times, out of hours and weekends there may be a callback service